

Scanning range
9 m

Photoelectric reflex switches

- Red light
- Low-cost sensor

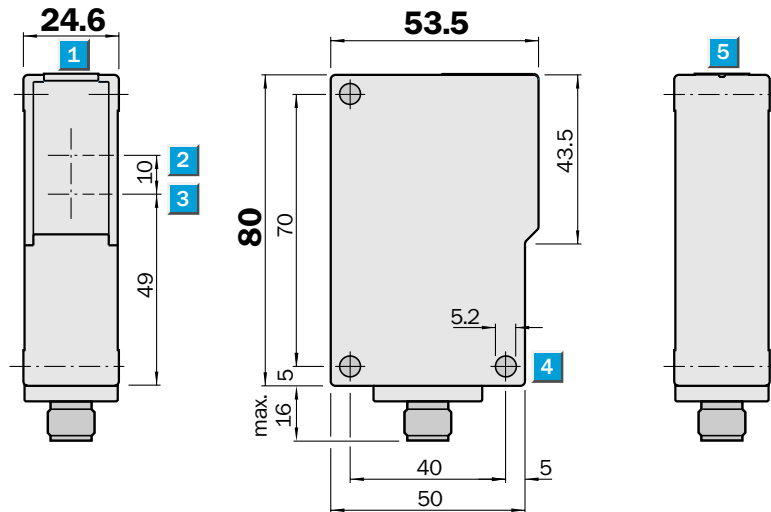

Dimensional drawing



- 1 Status indicator
- 2 Centre of optical axis, sender
- 3 Centre of optical axis, receiver
- 4 Mounting hole \varnothing 5.2 mm
- 5 Alignment sight

Connection types

WL 23-F 132

WL 23-F 430

WL 23-F 431

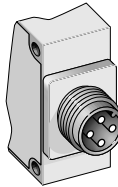
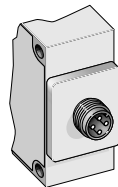
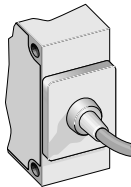

4 x 0.25 mm²

4-pin, M 12

4-pin, M 18

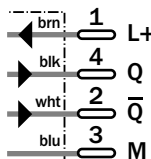
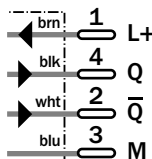
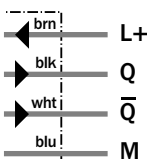

Accessories	page
Cable receptacles	496
Mounting brackets	510
Reflectors	520

Technical data	WL 23-	F 132	F 430	F 431										
-----------------------	--------	-------	-------	-------	--	--	--	--	--	--	--	--	--	--

Scanning range , max. typ./on reflector	9 m/PL 80 A			
Light source¹⁾, light type	LED, visible red light			
Light spot diameter	Approx. 40 mm at 2.70 m			
Supply voltage V_S	12 ... 24 V DC ($\pm 20\%$)			
Ripple ²⁾	$\leq 5 V_{SS}$			
Current consumption ³⁾	< 25 mA			
Switching outputs	PNP, Q and \bar{Q}			
Output current I_A max.	100 mA			
Response time ⁴⁾	2.5 ms			
Max. switching frequency ⁵⁾	200/s			
Connection types	Cable ⁶⁾ , 2 m			
	Plug, M 12, 4-pin			
	Plug, M 18, 4-pin			
VDE protection class⁷⁾	<input type="checkbox"/>			
Circuit protection⁸⁾	A, B, C			
Enclosure rating	IP 65			
Ambient temperature T_A	Operation $-25\text{ }^\circ\text{C} \dots +60\text{ }^\circ\text{C}$			
	Storage $-40\text{ }^\circ\text{C} \dots +70\text{ }^\circ\text{C}$			
Weight	Approx. 100 g			
Polarising filter				
Housing material	ABS			

- 1) Average service life 100,000 h at $T_A = +25\text{ }^\circ\text{C}$
- 2) May not exceed or fall short of V_S tolerances
- 3) Without load
- 4) Signal transit time with resistive load
- 5) With light/dark ratio 1:1
- 6) Do not bend below $0\text{ }^\circ\text{C}$
- 7) Reference voltage 50 V DC
- 8) A = V_S connections reverse-polarity protected
 B = Output Q and \bar{Q} short-circuit protected
 C = Interference pulse suppression

Scanning range and operating reserve

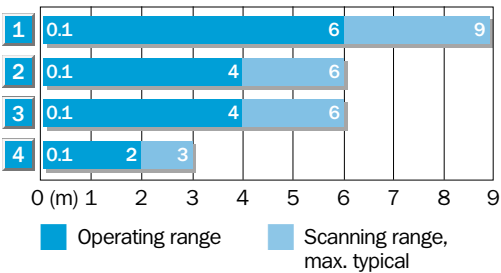

Reflector type	Operating range
1 PL 80 A	0.1...6.0 m
2 C 110	0.1...4.0 m
3 PL 40 A	0.1...4.0 m
4 PL 20 A	0.1...2.0 m

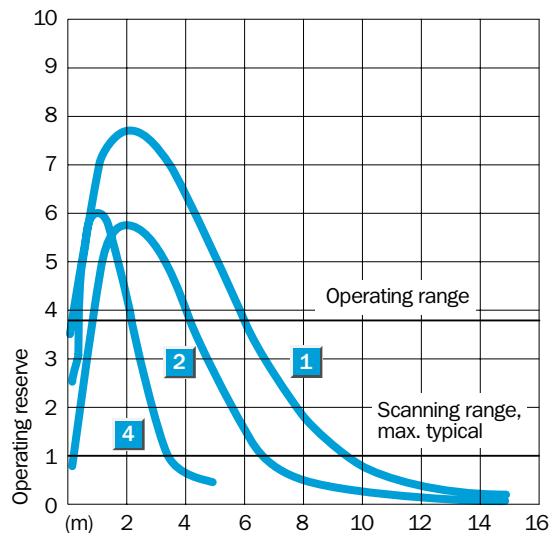

Order information

Type	Part no.
WL 23-F 132	1 015 686
WL 23-F 430	1 015 684
WL 23-F 431	1 015 685



Scanning range
9 m

Photoelectric reflex switches

- Red light
- Low-cost sensor

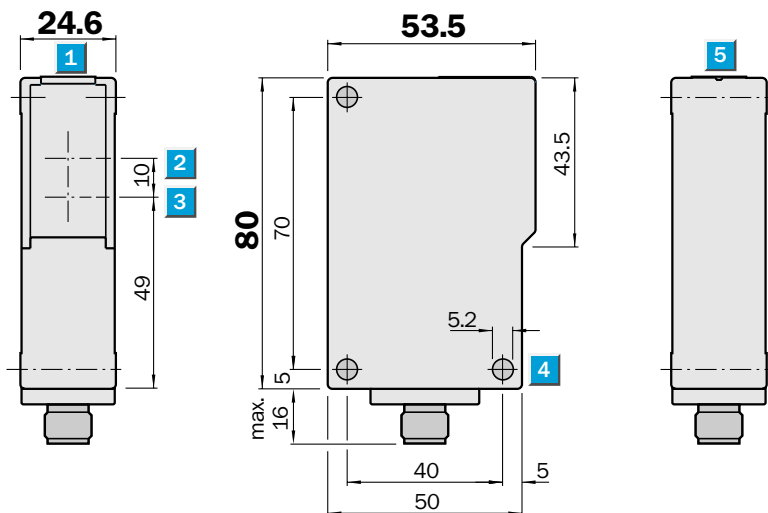

Dimensional drawing



- 1 Status indicator
- 2 Centre of optical axis, sender
- 3 Centre of optical axis, receiver
- 4 Mounting hole \varnothing 5.2 mm
- 5 Alignment sight

Connection types

WL 23-S 132 WL 23-S 730

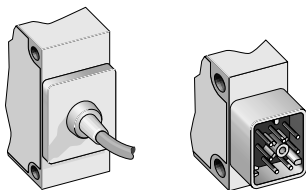

5 x 0.25 mm² 7-pin

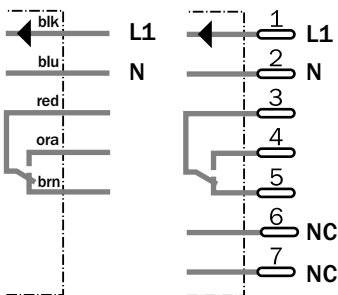

Accessories	page
Cable receptacles	496
Mounting brackets	510
Reflectors	520

Technical data		WL 23-	S 132	S 730								
Scanning range , max. typ./on reflector	9 m/PL 80 A											
Light source¹⁾, light type	LED, visible red light											
Light spot diameter	Approx. 40 mm at 2.70 m											
Supply voltage V_S	90...265 V AC											
Power consumption	< 2 VA											
Switching outputs	Relay, SPDT, isolated ²⁾											
Max. switching voltage	90...265 V AC											
Max. switching current	2.5 A											
Max. switching capacity	150 VA											
Response time	6 ms											
Max. switching frequency ³⁾	10/s											
Connection types	Cable ⁴⁾ , 2 m											
	Cube connector, 7-pin											
VDE protection class⁵⁾	□											
Circuit protection⁶⁾	A, C											
Enclosure rating	IP 65											
Ambient temperature T_A	Operation - 25 °C...+ 60 °C											
	Storage - 40 °C...+ 75 °C											
Weight	Approx. 100 g											
Polarising filter												
Housing material	ABS											

- 1) Average service life 100,000 h at T_A = + 25 °C
- 2) Provide suitable spark suppression for inductive or capacitive loads
- 3) With light/dark ratio 1:1
- 4) Do not bend below 0 °C
- 5) Reference voltage 250 V AC
- 6) A = V_S connections reverse-polarity protected
C = Interference pulse suppression

Scanning range and operating reserve

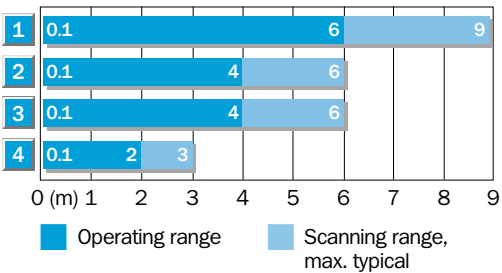

Reflector type	Operating range
1 PL 80 A	0.1...6.0 m
2 C 110	0.1...4.0 m
3 PL 40 A	0.1...4.0 m
4 PL 20 A	0.1...2.0 m

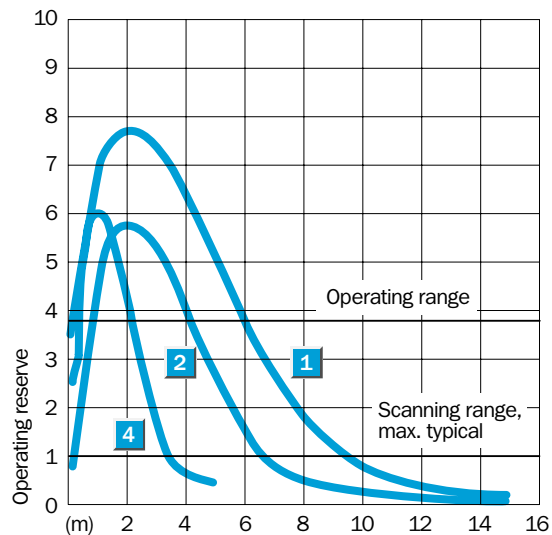

Order information

Type	Part no.
WL 23-S 132	1 015 687
WL 23-S 730	1 015 688